

URINE DRAINAGE BAGS

Urological Drainage



STERILE CLOSED SYSTEM BAGS

Designed for prolonged, hygienic urine collection

UNOQUIP closed urine drainage systems with a drip chamber include an additional chamber between the tubing and the urine bag, interrupting the urine flow. This configuration creates a distinct secondary system comprising the catheter and tubing, separate from the bag. These systems are intended for multi-day use and are recommended to help reduce the risk of catheter-associated urinary tract infections (CAUTI).¹

Q6 CLOSED SYSTEM BAGS

Sterile urine bags with Non-Return Valve and drip chamber

- With long, vented drip chamber and additional Non-Return Valve, designed to reduce catheter-associated urinary tract infections
- Equipped with integrated needle-free sampling port
- 2000ml bag volume
- Fold-away T-tap bottom outlet with 2 stoppers
- Tube length: 120cm
- Integrated bed hanger and cord

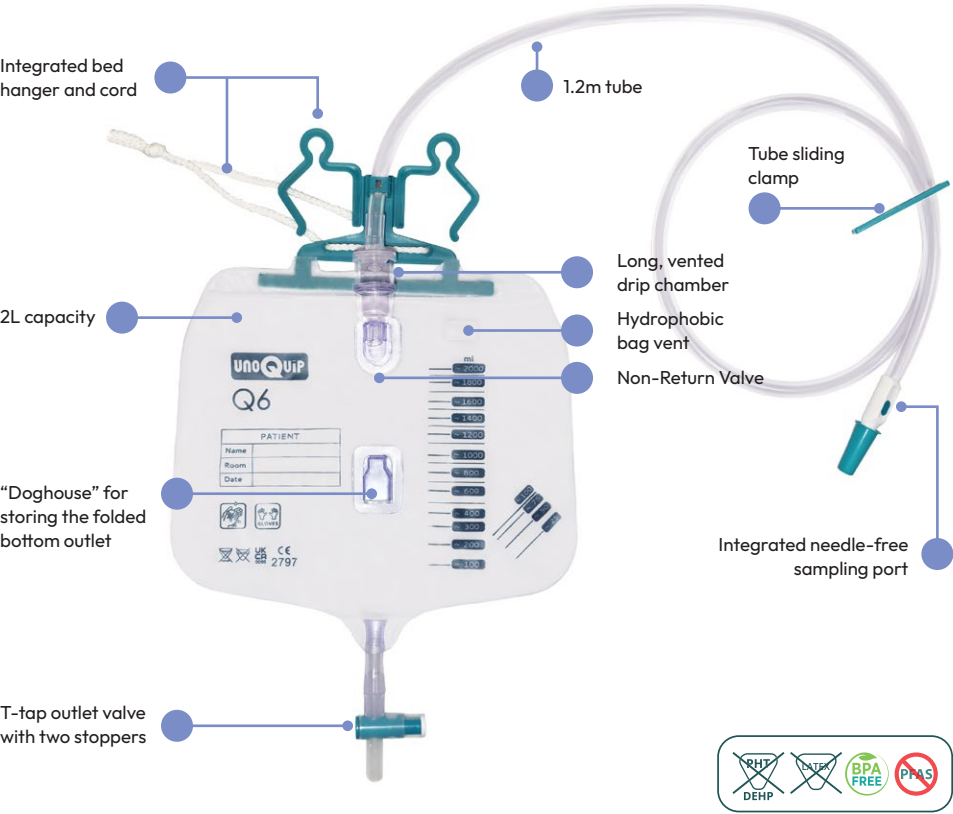

Reference	Tube length (cm)	Tube ID/OD (mm)	Bag capacity (ml)	Pack QTY.
41014918	120	7.4/10.0	2000	1/10/40

Q4000 4L TUR AND HAEMATURIA IRRIGATION BAG

Sterile urine bags with Non-Return Valve and drip chamber

- With long, vented drip chamber and additional Non-Return Valve, designed to reduce catheter-associated urinary tract infections
- Fold-away T-tap bottom outlet with 2 stoppers
- Equipped with integrated needle-free sampling port
- 4000ml bag volume
- Tube length: 125cm
- With integrated bed hanger and cord
- Available with or without pump ball. The pump ball version includes two tubing clamps to direct flow either to the bladder or to the bag.

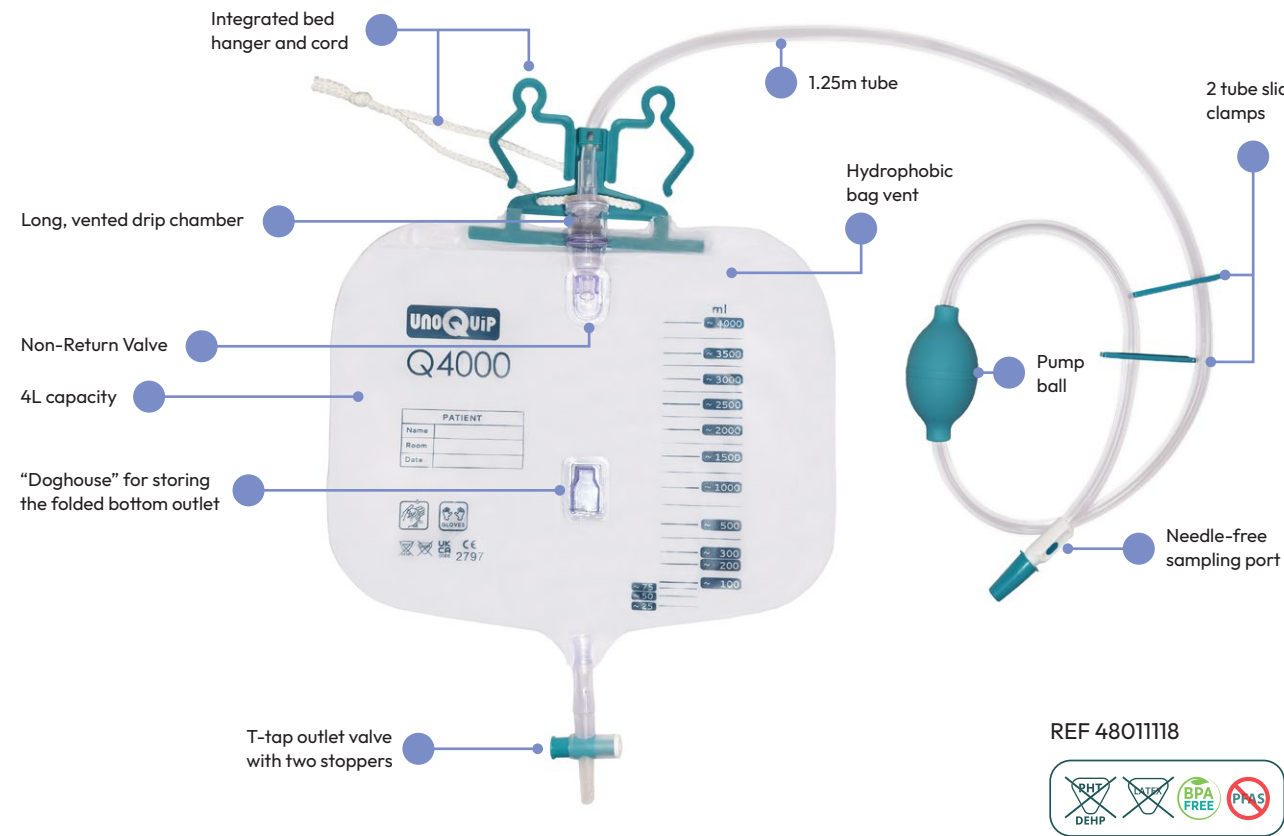

Reference	Pumpball	Tube length (cm)	Tube ID/OD (mm)	Bag capacity (ml)	Pack QTY.
48011018	-	125	7.4/10.0	4000	1/10/40
48011118	Yes	125	7.4/10.0	4000	1/10/40

REF 48011118

DEHP FREE BPA FREE PMS

STERILE CLOSED SYSTEM BAGS

Designed for prolonged, hygienic urine collection

Q6+ PRE-CONNECTED STERILE CLOSED SYSTEM BAGS

With silicone Foley catheter

Pre-connected urinary drainage systems offer optimal infection prevention in routine care. A tamper-evident seal protects the catheter connection, helping to reduce the risk of ascending infections and accidental disconnection. If needed, the seal can be removed without compromising sterility. The pre-connection also eliminates assembly steps and reduces handling errors during catheterisation.

- Pre-connected to a UNOQUIP long-term (<90 days) silicone Foley catheter with Nelaton (cylindrical) tip
- Tamper-evident seal prevents accidental disconnection
- With long, vented drip chamber and additional Non-Return Valve, designed to reduce catheter-associated urinary tract infections
- Fold-away T-tap bottom outlet with 2 stoppers
- Equipped with integrated needle-free sampling port
- 2000ml bag volume
- Tube length: 120cm

THE Q6+ SYSTEM

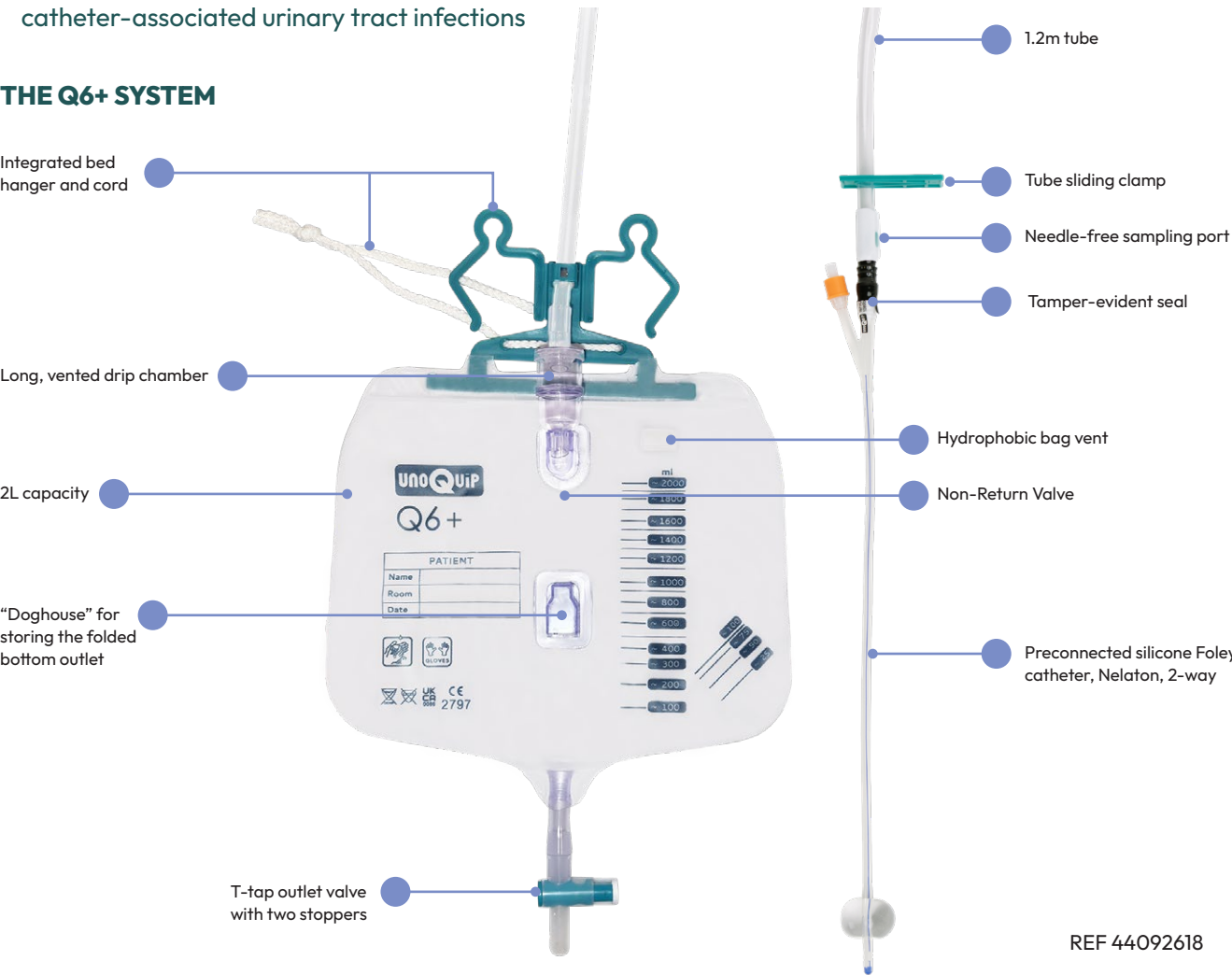

REF 44092618

THE SILICONE FOLEY CATHETER OF THE Q6+ SYSTEM



- X-ray visible, gently rounded, cylindric Nelaton tip with two large drainage eyelets
- Made from medical-grade silicone: designed to provide reliable passage while facilitating comfort during long-term catheterisation.^{2,3,4,5,6,7}
- Entirely PVC-free (PVC material may still be utilised by other brands for the valve)
- Can be retained in the human body for up to 90 days

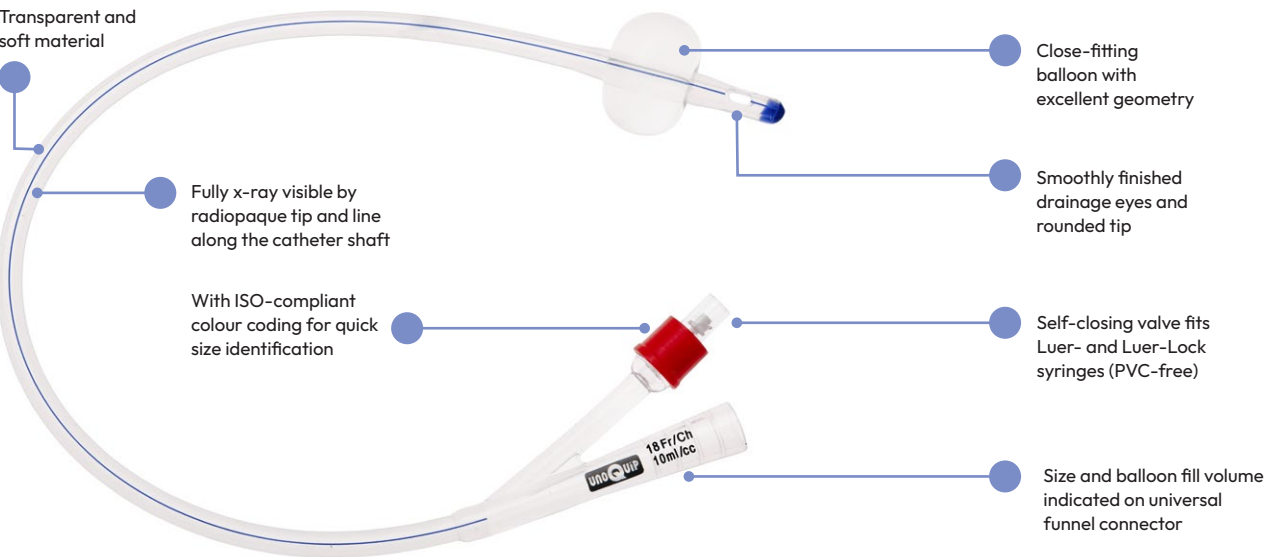

Reference	Catheter size (CH/Fr.)	Tube length (cm)	Tube ID/OD (mm)	Bag capacity (ml)	Pack QTY.
44092418	14	120	7.4/10.0	2000	1/10/40
44092618	16	120	7.4/10.0	2000	1/10/40
44092818	18	120	7.4/10.0	2000	1/10/40

UNOQUIP offers a wide range of silicone Foley catheters.



Please get in touch with us to learn more.

References:
1 Mielke M, Ruscher C. Empfehlungen zur Prävention und Kontrolle Katheter-assoziiierter Harnwegsinfektionen: Aktualisierte Empfehlung der KRINKO vom Juni 2015. Berlin: Robert Koch-Institut; 2015; 2 Nacey JN, Tulloch AGS, Ferguson AF. Catheter-induced urethritis: A comparison between latex and silicone catheters in a prospective clinical trial. Br J Urol. 1985;57:325-328; 3 Huang W, Wei L, Ji Y, Xu D, Mo J. Effect of silicon and latex urinary catheters: A comparative study. J South Med Univ. 2005;25(8):1026-1028; 4 Tunney MM, Keane PF, Gorman SP. Assessment of urinary tract biomaterial encrustation using a modified Robbins device continuous flow model. J Biomed Mater Res. 1997;38(2):8; 5 Morris NS, Stickler DJ, Winters C. Which indwelling urethral catheters resist encrustation by Proteus mirabilis biofilms? Br J Urol. 1997;80:58-6; 6 European Association of Urology Nurses. Evidence-based guidelines for best practice in urological health care: Indwelling catheterisation in adults, Urethral and suprapubic. 2024; 7 Mercer Smith J. Indwelling catheter management: From habit-based to evidence-based practice. Ostomy Wound Manage. 2003;49(12):34-45.

STERILE CLOSED SYSTEM BAGS

Designed for prolonged, hygienic urine collection

Q4 CLOSED SYSTEM BAGS

Sterile urine bags with Non-Return Valve and needle-free sampling port

- With Non-Return Valve to prevent urine reflux
- Fold-away T-tap bottom outlet with 2 stoppers
- Equipped with integrated needle-free sampling port
- Hydrophobic bag vent
- 2000ml bag volume
- Tube length: 120cm
- Available with and without bed hanger

REF 38016218

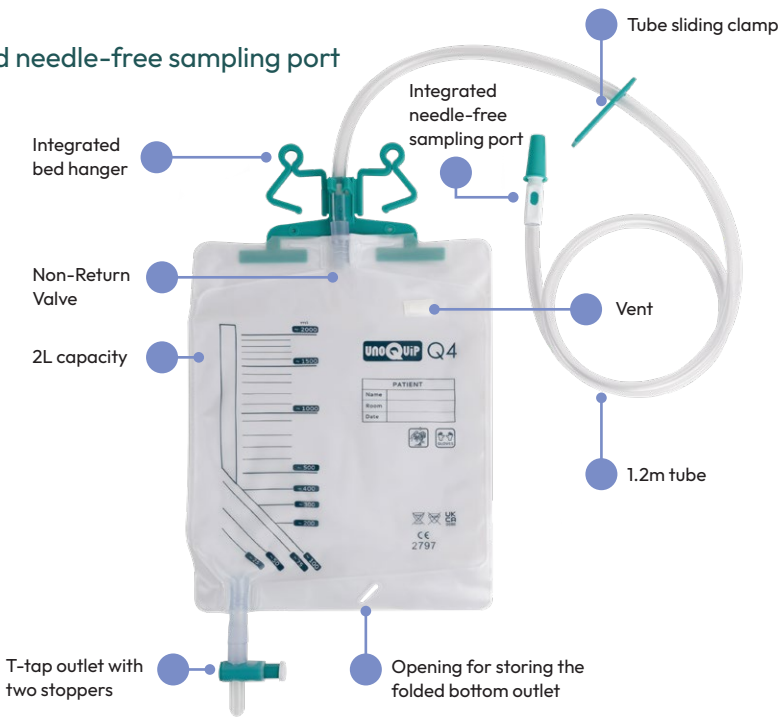

Reference	Hanger	Tube length (cm)	Tube ID/OD (mm)	Bag capacity (ml)	Pack QTY.
38016218	Yes	120	7.4/10.0	2000	1/10/40
38016318	-	120	7.4/10.0	2000	1/10/40
38016418	-	100	7.4/10.0	2000	1/10/40

QE4 CLOSED SYSTEM BAGS

Sterile urine bags with Non-Return Valve and needle-free sampling port

- With Non-Return Valve to prevent urine reflux
- T-tap bottom outlet with 2 stoppers
- Equipped with integrated needle-free sampling port
- Hydrophobic bag vent
- 2000ml bag volume
- Tube length: 120cm



Reference	Tube length (cm)	Tube ID/OD (mm)	Bag capacity (ml)	Pack QTY.
38012618	120	7.4/10.0	2000	1/10/40

NON-STERILE DRAINAGE BAGS

- Large selection of non-sterile drainage bags, with or without Non-Return Valve and bottom outlet
- Choice of various tube lengths for different care situations
- Individually wrapped (single-pack) options for hygienic distribution

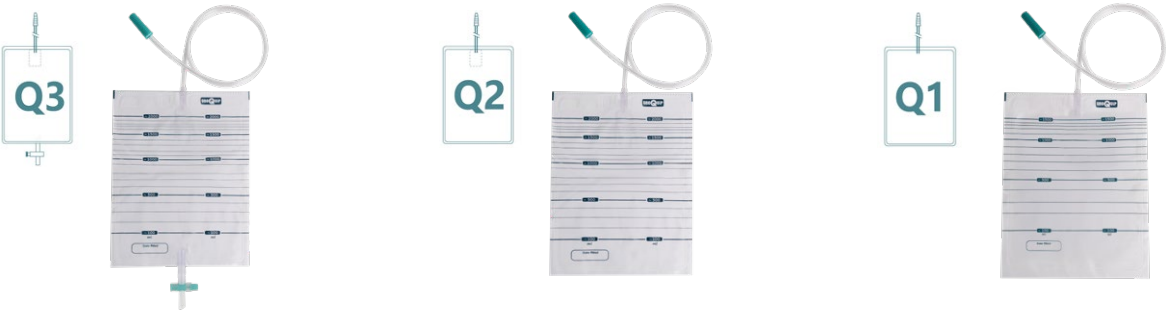

- With Non-Return Valve preventing urine reflux
- T-tap bottom outlet allows hygienic bag emptying
- 2L bag size
- Tube lengths: 90cm, 110cm, 120cm, 140cm
- Option with enlarged tubing lumen for accelerated drainage of larger volumes
- Single-packed option available
- With Non-Return Valve preventing urine reflux
- Tear-open feature enables easy bag emptying
- 1.5L and 2L bag sizes
- Tube lengths: 10cm, 35cm, 90cm, 110cm, 120cm
- Single-packed option available
- Tear-open feature enables easy bag emptying
- 1.5L and 2L bag sizes
- Tube lengths: 90cm or 130cm
- Single-packed option available



Reference	Tube length (cm)	Tube ID/OD (mm)	Bag capacity (ml)	Pack QTY.	Pack type
Q3 - With Non-Return Valve and Bottom Outlet					
37035118	90	4.9/6.5	2000	25/250	Bulk
37045218	110	4.9/6.5	2000	30/300	Bulk
37046018	140	4.9/6.5	2000	25/250	Bulk
37013018	90	4.9/6.5	2000	1/50/200	Single
37014018	120	4.9/6.5	2000	1/50/200	Single
37015018	110	7.4/10.0	2000	1/-/100	Single
Q2 - With Non-Return Valve					
35103218	10	4.9/6.5	1500	25/250	Bulk
35103118	35	4.9/6.5	1500	25/250	Bulk
35100518	90	4.9/6.5	1500	25/250	Bulk
35100618	110	4.9/6.5	1500	25/250	Bulk
35103018	90	4.9/6.5	2000	25/250	Bulk
35113018	90	4.9/6.5	2000	1/50/200	Single
35114018	120	4.9/6.5	2000	1/50/200	Single
Q1 - Without Non-Return Valve					
35000518	90	4.9/6.5	1500	25/250	Bulk
35003018	90	4.9/6.5	2000	25/250	Bulk
35090918	130	4.9/6.5	2000	30/300	Bulk
35013018	90	4.9/6.5	2000	1/50/200	Single



Tear-open feature



T-tap bottom outlet



Single-Pack

NON-STERILE DRAINAGE BAGS

Q3+ URINE DRAINAGE BAGS

Non-sterile urine bags with Non-Return Valve and use-once bottom outlet

- Use-once drainage outlet ensures single-use of the bag
- With Non-Return Valve preventing urine reflux
- 2000ml bag volume
- Tube length: 90cm
- Single-packed for hygienic distribution



Use-once Bottom Outlet

The plunger can only be operated one time and is initially blocked by a clip.



To empty the bag, remove the clip, then push the plunger into the housing.

The plunger cannot be removed again, and the bag needs to be changed.

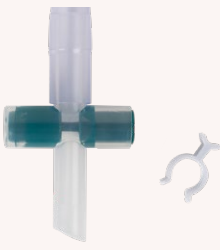

Reference	Tube length (cm)	Tube ID/OD (mm)	Bag capacity (ml)	Pack QTY.
55000318	90	4.9/6.5	2000	Single packed 1/50/200

EMPTY BAGS

Non-sterile bags for the hygienic disposal of urine from diuresis measuring systems such as the UNOQUIP Q500 Plus urine meter

- Female connector for attachment to urine meter bottom outlets
- Use-once drainage outlet ensures single-use of the bag
- With Non-Return Valve preventing urine reflux
- 2000ml bag volume
- Tube length: 38cm
- Single-packed for hygienic distribution



Reference	Tube length (cm)	Tube ID/OD (mm)	Bag capacity (ml)	Pack QTY.
55003818	38	4.9/6.5	2000	Single packed 1/50/200

URINE BAG ACCESSORIES

URINE BED HANGERS

- One-piece moulded design
- Two double pins for flexible compatibility with various urine bags
- Integrated holder keeps drainage tubing in place



Reference	Description	Pack QTY.
62219018	Urine Bag Hanger, 1-part, double-pin, for Q1, Q2, Q3, Q3+, and Empty bags	250
62219018	Urine Bag Hanger, 1-part, double-pin, for Q4, QE4 bags	250

FT CATHETER FIXATION TAPE

Fast and reliable fixation of catheters and tubes



CORRECT POSITIONING AND REPOSITIONING

The wings can be opened and closed repeatedly, allowing for repositioning of the catheter or tube.

PATIENT COMFORT

Flexible material conforms to the patient's body, minimising catheter movement and discomfort.

Soft foam reduces pressure points and the risk of pressure injuries.

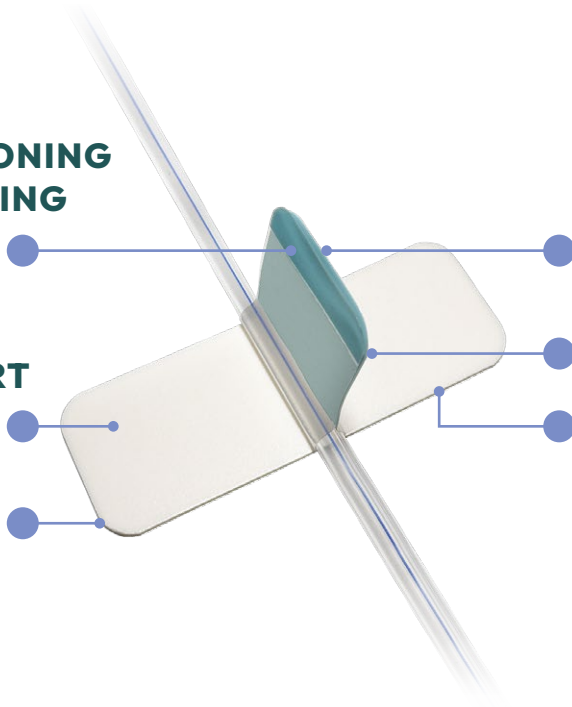

EASY TO USE

Two wings coated with a special adhesive allow for fast securement of catheters and tubes, designed to prevent accidental displacement.

Blue non-stick film with different lengths ensures easy application, even with gloves.

Adhesive PU-foam base coated with a skin-friendly polyacrylate adhesive allows easy and secure application to the patient's skin.



Scan to learn more and watch the video

FT Catheter Fixation Tape is suitable for anchoring a variety of devices to the patient's skin, including urinary catheters, nephrostomy tubes, infusion lines, chest drains, central venous lines, wound drains, and peritoneal dialysis tubes. Accommodates catheters and tubes with CH/Fr. 8-36.

Ref.	Description	Pack QTY.
Q37449	FT Catheter Fixation Tape, 102x38mm	1/50/600

URINE LEG BAGS

Discrete and comfortable urine collection for hospital and home care



Our versatile leg bag range is available in three sizes (350, 500 and 750ml), with short or long tubing, plus a choice of lever tap or T-tap outlet.

Each bag is anatomically shaped for comfort and features a universal connector compatible with all catheters and sheaths, a Non-Return Valve, and flexible tubing. Optional features include an integrated needle-free sampling port and soft backing.

All bags are compatible with standard straps or sleeves and are free from latex, phthalates, BPA, and PFAS.

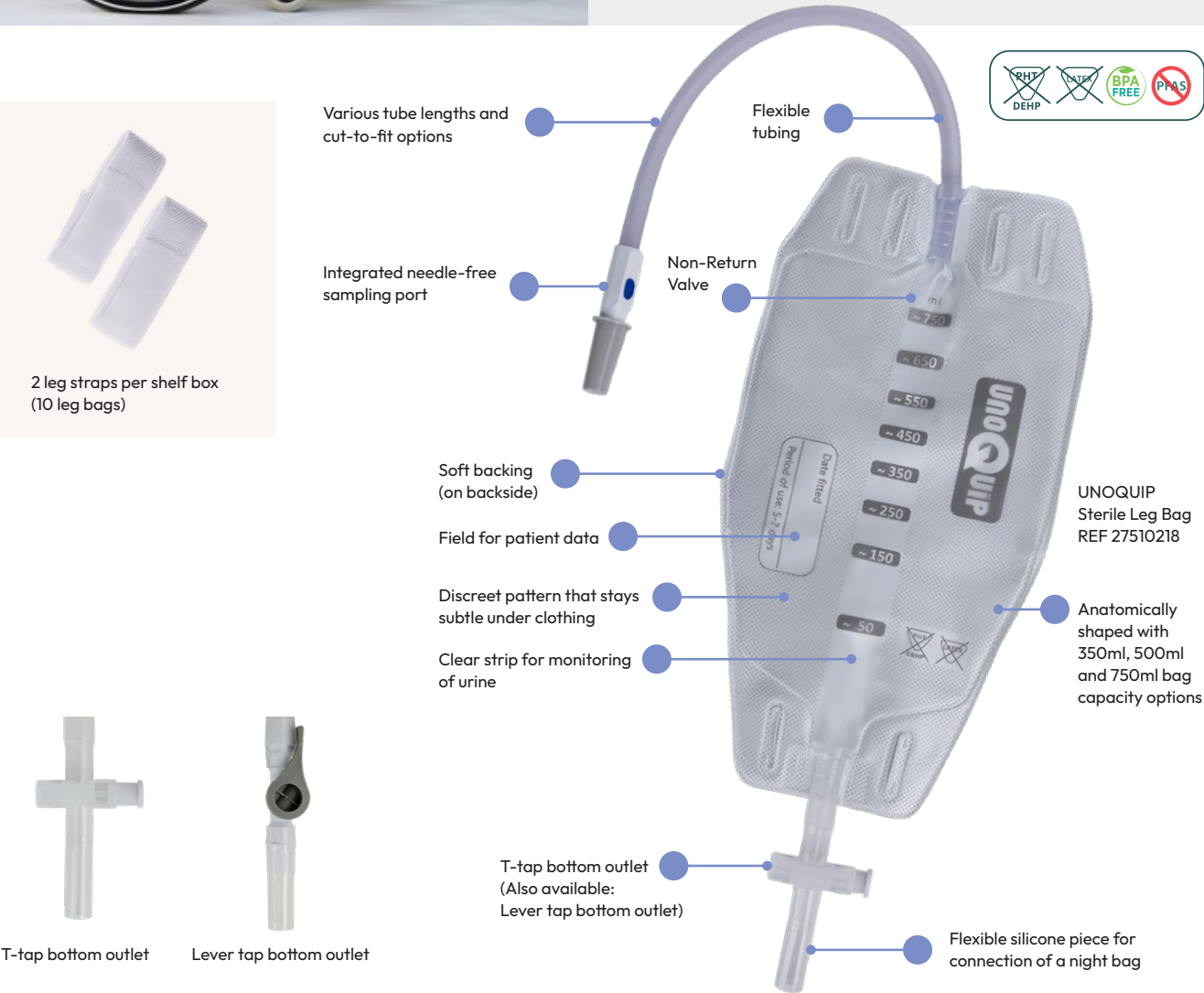

- Anatomically shaped for comfortable fit
- Non-Return Valve prevents urine reflux
- Choice of T-tap or Lever tap bottom outlet
- Variants with soft backing for enhanced comfort
- Tube lengths: 9/10cm, 30cm, and 50cm – cut-to-fit
- Includes 2 leg straps per shelf box (10 leg bags)
- Sterile bags with needle-free integrated sampling port



Reference	Bottom outlet	Soft backing	Tube length (cm)	Needle-free sample port	Cut-to-fit tube	Bag capacity (ml)	Pack QTY.
Sterile Leg Bags							
23510218	T-tap	Yes	9	Yes	-	350	1/10/80
23510118	T-tap	Yes	30	Yes	-	350	1/10/80
25010118	T-tap	-	9	Yes	-	500	1/10/80
25010218	T-tap	-	30	Yes	-	500	1/10/80
25010618	Lever tap	-	9	Yes	-	500	1/10/80
25010518	Lever tap	-	30	Yes	-	500	1/10/80
25010418	T-tap	Yes	9	Yes	-	500	1/10/80
25010318	T-tap	Yes	30	Yes	-	500	1/10/80
25010818	Lever tap	Yes	9	Yes	-	500	1/10/80
25010718	Lever tap	Yes	30	Yes	-	500	1/10/80
27510118	T-tap	Yes	10	-	-	750	1/10/80
27510918	T-tap	Yes	50	-	Yes	750	1/10/80
27510318	T-tap	Yes	9	Yes	-	750	1/10/80
27510218	T-tap	Yes	30	Yes	-	750	1/10/80
27510418	Lever tap	Yes	9	Yes	-	750	1/10/80
27510518	Lever tap	Yes	30	Yes	-	750	1/10/80
Non-Sterile Leg Bags							
25000118	T-tap	Yes	10	-	-	500	10/80
25000218	T-tap	Yes	50	-	Yes	500	Single packed 1/10/80
25000318	Lever tap	Yes	10	-	-	500	Single packed 1/10/80
25000418	Lever tap	Yes	50	-	Yes	500	10/80
27500118	T-tap	Yes	10	-	-	750	10/80
27500218	T-tap	Yes	50	-	Yes	750	Single packed 1/10/80

About UNOQUIP

At UNOQUIP we are dedicated to improving patient outcomes by providing single-use medical device solutions to health care professionals and business partners. Our offering includes products in the areas of fluid management, urological drainage, airway management, respiratory care, surgical suction, and nursing care.

Our company was founded by a group of medical device professionals committed to fill the gap caused by companies that are withdrawing their focus from or exiting the global hospital care market. For us, this business is about much more than selling medical products. We are a highly engaged team with a passion for what we do.

At UNOQUIP, we strive to be recognised as the experts in single-use medical device solutions, closely partnering with our customers, providing them superior products with exceptional services to improve outcomes in patient care.

Discover Our Complete Range of Urological Drainage Solution

We offer a full portfolio of urological drainage solutions for hospital and home care, including an extensive range of Foley catheters, intermittent catheters, male external catheters, and catheter accessories. Do you want to learn more? Get in touch with us!

We look forward to hearing from you!

UNOQUIP Team

CONTACT US TO LEARN MORE



Scan to enter
our website

UNOQUIP GmbH
Schützengraben 20
8200 Schaffhausen
Switzerland

✉ info@unoquip.com

🌐 www.unoquip.com

